

PD080726

Hearing Date: June 26, 2009

Exhibit I

Application for Restroom/Office Building (withdrawn)

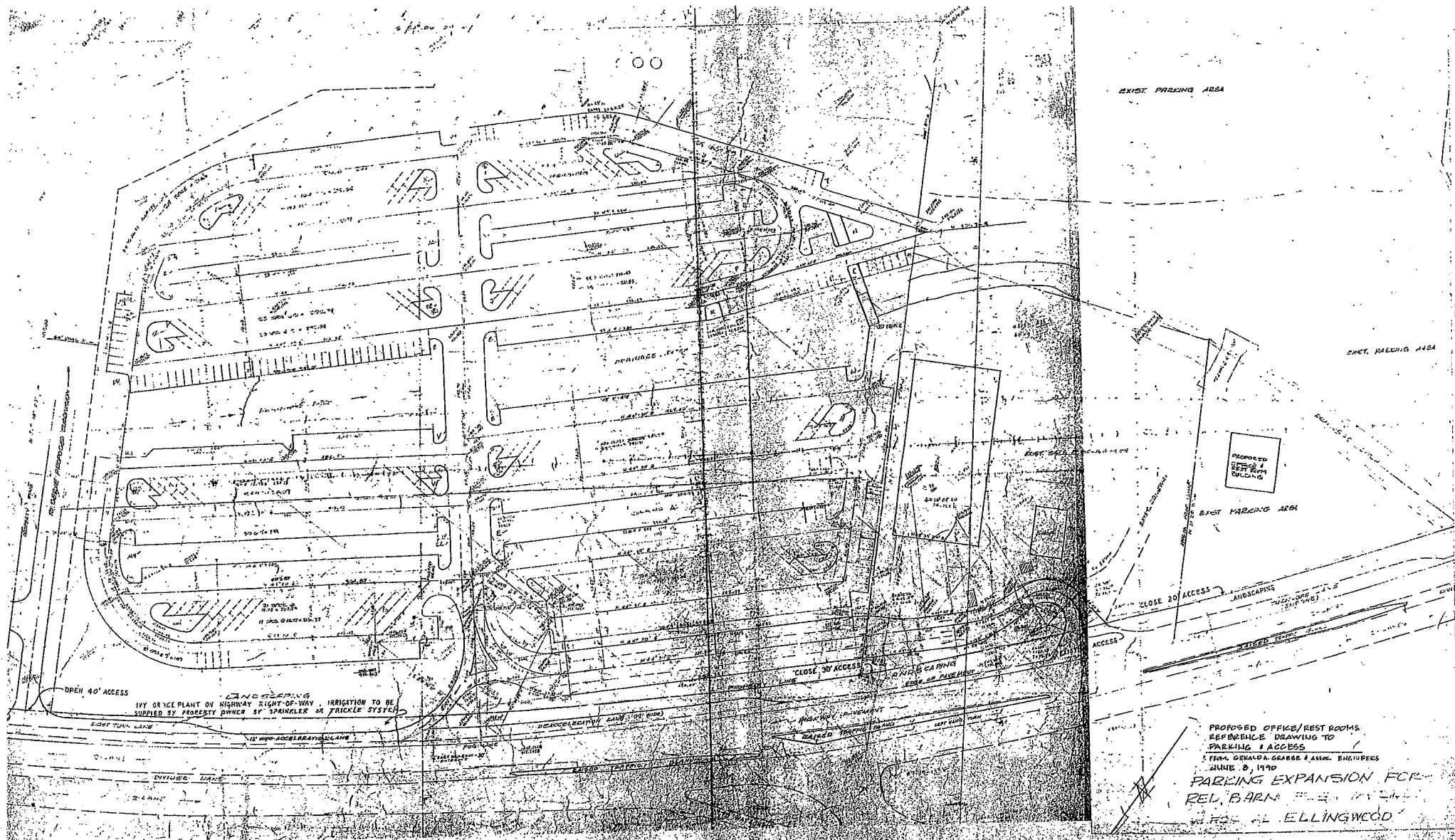

EXIST. PARKING AREA

EXIST. PARKING AREA

PROPOSED OFFICE/REST ROOMS

EXIST. PARKING AREA

CLOSE 20' ACCESS

CLOSE 30' ACCESS

DREN 40' ACCESS
IRVING OR ICE PLANT ON HIGHWAY RIGHT-OF-WAY, IRRIGATION TO BE SUPPLIED BY PROPERTY OWNER BY SPRINKLER OR TRICKLE SYSTEM

PROPOSED OFFICE/REST ROOMS
 REFERENCE DRAWING TO
 PARKING # ACCESS
 FROM GERALD A. GRABBE & ASSOC. ENGINEERS
 JUNE 8, 1990
 PARKING EXPANSION FOR
 REL. BARN
 FOR A. L. ELLINGWOOD